

Were you invited to help us shape the future of mobility?

# Let's get started!

Did you receive an invitation from ETH's Institute for Transport Planning and Systems to be part of the **TimeUse+** Study? Follow these three simple steps and start tracking today!



## 1. Install the app



Go to the Play Store, search for "**TimeUse+**" and **install** the app

Have your invitation letter at hand. You will need your **registration code** to proceed



## 2. Registration

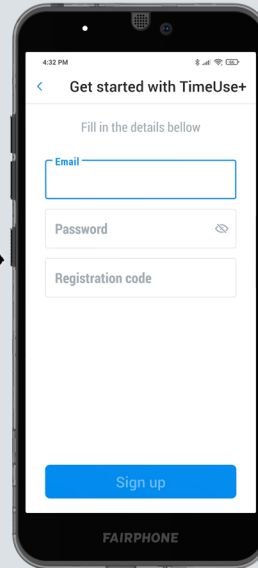

Once installed, **open** the app and fill in:

- E-Mail**  
example@swissmail.com
- Password**  
Minimum 6 characters you choose
- Registration code**  
Find it in your invitation letter

**Problems?**  
**contact us**  
timeuse@ethz.ch

## 3. Log in and first settings

After registering you can normally log in providing only your email and password. **For the first time you log in, it is very important to choose the correct settings:**

### Location



Allow the app to use your location **ALWAYS**

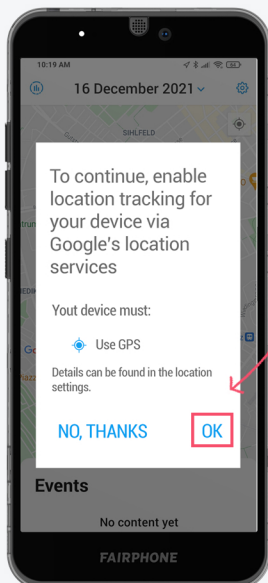

1 **Select OK**

2 **Allow us to use your location**

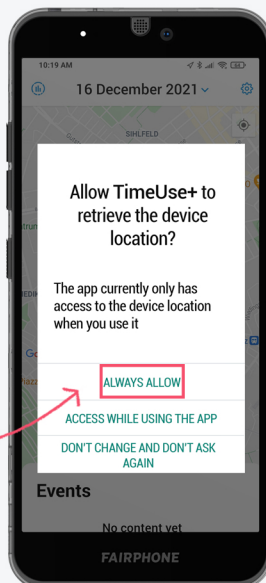

### Further settings

Due to the variety of phones, each configuration will be slightly different. Please adjust the following directly in your phone's settings:

#### Battery



**Disable** battery optimization and power saving mode for the app



**Allow** background services and activities

#### Activity recognition



**Enable** access to sensor data such as body movements

**Check the**  
**FAQs**  
**Manual!**  
timeuse.ethz.ch